

Elicon configurations data sheet

Configuration Elicon 1:

Single Flatscreen workstation for up to four flatscreen monitors 19"

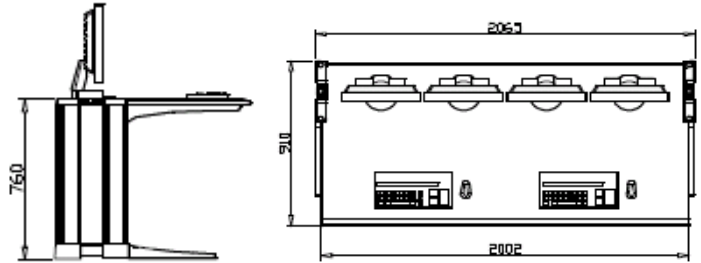

Dimensions:

Height 760mm

Width 2065mm (worktop 2002mm)

Depth 910mm

Consists of:

2x Elicon side pieces with continuous vertical cover on the outside, height 760mm

1x Elicon worktop D900mm W2000mm

Material:

Side pieces:

extruded aluminium with die cast aluminium stabilizer and head-piece

vertical covers: sheet-steel, roller-formed

Worktop:

Crosspiece: extruded aluminium and roller-formed sheet-steel

support arms: sheet-steel

worktop: 3-layer particle board, FP/Y E1 version, fire protection class B2

worktop cover: high pressure plastic laminate HPL

Finish:

Side pieces: powder-coated RAL 7035 light grey

Head pieces: powder-coated RAL 5003 sapphire blue

Worktop: RAL 7035 light grey

How supplied:

Pre-assembled modules

Please note:

Delivery without flatscreens, computers or any other desktop devices or accessories.

Order number: 04.252.250.2

Configuration Elicon 2:

Single Computer workstation with shelf, lamp „Diva“, rear panels and PC-adapter

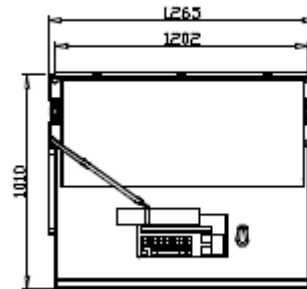
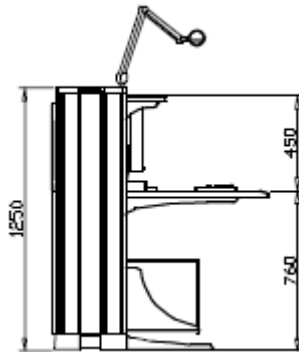

Dimensions:

Height 760/1250mm

Width 1265mm (worktop 1202mm)

Depth 1010mm

Computer mounting: width adjustable: 165mm – 265mm

Consists of:

2x Elicon side pieces with continuous vertical cover on the outside, height 1250mm

1x Worktop D1000mm W1200mm

1x Elicon superstructure level, system W1200mm D500mm

1x Elicon computer mounting (side)

1x perforated rear panel H682mm

1x perforated rear panel H410mm

1x lamp „Diva“ with lamp adapter



Material:

Side pieces:

extruded aluminium with die cast aluminium stabilizer and head-piece

vertical covers: sheet-steel, roller-formed

Worktop and superstructure level:

Crosspiece: extruded aluminium and roller-formed sheet-steel

support arms: sheet-steel

worktop: 3-layer particle board, FP/Y E1 version, fire protection class B2

worktop cover: high pressure plastic laminate HPL

Computer mounting and perforated rear panel: sheet steel

Finish:

Side pieces, rear panels, computer mounting: powder-coated RAL 7035 light grey

Head pieces: powder-coated RAL 5003 sapphire blue

Worktop: RAL 7035 light grey

Lamp Diva: Silver

How supplied:

Pre-assembled modules

Please note:

Delivery without flatscreens, computers or any other desktop devices or accessories.

Order number: 04.252.251.2

Configuration Elicon 3:

Workstation combination with desktop console and two mobile drawer units

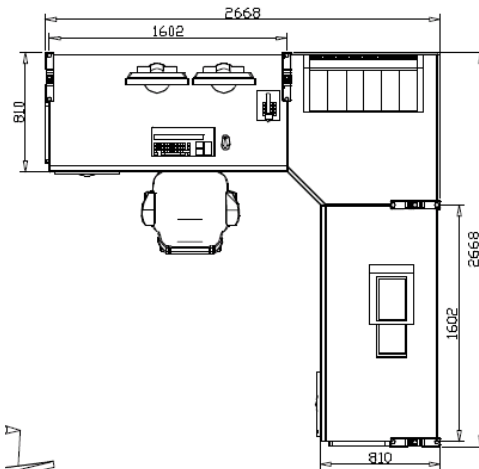
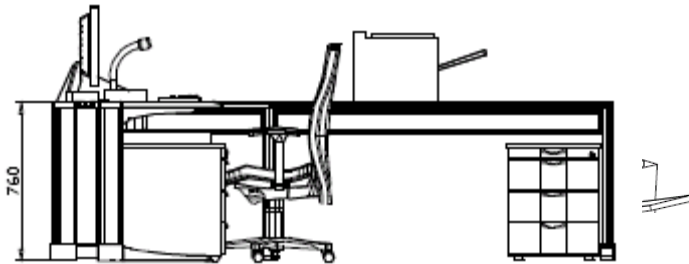

Dimensions:

Height 760mm

Width 2668mmx2668mm (worktops 1602mm)

Depth 810mm

Desktop console: W760mm, D420mm

Front panel dimensions: W120mm, H305mm, Gauge 3mm

Consists of:

2x Elicon side pieces with continuous vertical cover on the outside, height 760mm

2x Elicon side pieces with segmented vertical covers on the outside, height 760mm

2x Worktops D800mm W1600mm

1x wall corner desk 90°

1x desktop console with 6x front panels

2x mobile drawer units 3x3 OU

Material:

Side pieces:

extruded aluminium with die cast aluminium stabilizer and head-piece

vertical covers: sheet-steel, roller-formed

Worktops and corner desk:

Crosspiece: extruded aluminium and roller-formed sheet-steel

support arms: sheet-steel

worktops, corner desk and desktop console: 3-layer particle board, FP/Y E1 version, fire protection class B2

worktops, corner desk and desktop console covers: high pressure plastic laminate HPL

Front panels: aluminium 3mm

Mobile drawer units:

Main unit and top cover: three layer particle board, FP/Y E1 version, directly coated, fire protection class B2

Drawer trim and drawer handle: plastic (PS)

Drawer tray: sheet steel in black

Castor diameter: 37 mm

Finish:

Side pieces: powder-coated RAL 7035 light grey

Head pieces: powder-coated RAL 5003 sapphire blue

Worktops, desktop console, mobile drawer units: RAL 7035 light grey

Front panels of desktop console: RAL 9006 white aluminium

How supplied:

Pre-assembled modules

Please note:

Delivery without chairs, flatscreens, computers or any other desktop devices or accessories.

Order number: 04.252.252.2